

**GENERAL NOTES**

THE DIE SHOWN HEREON IS A TYPICAL 1.25" TUBE DIE AS MANUFACTURED BY JD SQUARED. THIS DIE CONFIGURATION IS DESIGNED FOR A FULL 180 DEGREE BEND WHICH IS SELDOM USED IN CYCLE FRAME CONSTRUCTION). MAKE SURE YOU ORDER A 'TUBING' DIE AND NOT A PIPE DIE. BE SURE THAT THE CAMPING U-STRAP COMES WITH THE DIE SET AS WELL AS THE FOLLOW BAR. THE U-STRAP TENSION BOLT IN THE DIE IS GENERALLY NOT NEEDED ON TUBING WITH A WALL THICKNESS OF .120" OR LESS.

**GARY W. WEISHAUP**  
 PERFORMANCE ENGINEERING  
 CHASSIS FABRICATION  
 FLOWBENCH TESTING  
 MACHINE WORK  
 RESTORATIONS

1400 RIVER PARK BLVD.  
 NAPA, CALIFORNIA 94559  
 PH: 707-252-3427  
 FAX: 707-252-3427  
 email: gw@chassisfab.net

Revision	Date
* INITIAL LAYOUT	12-7-04
* GENERAL REVISION	7-20-06

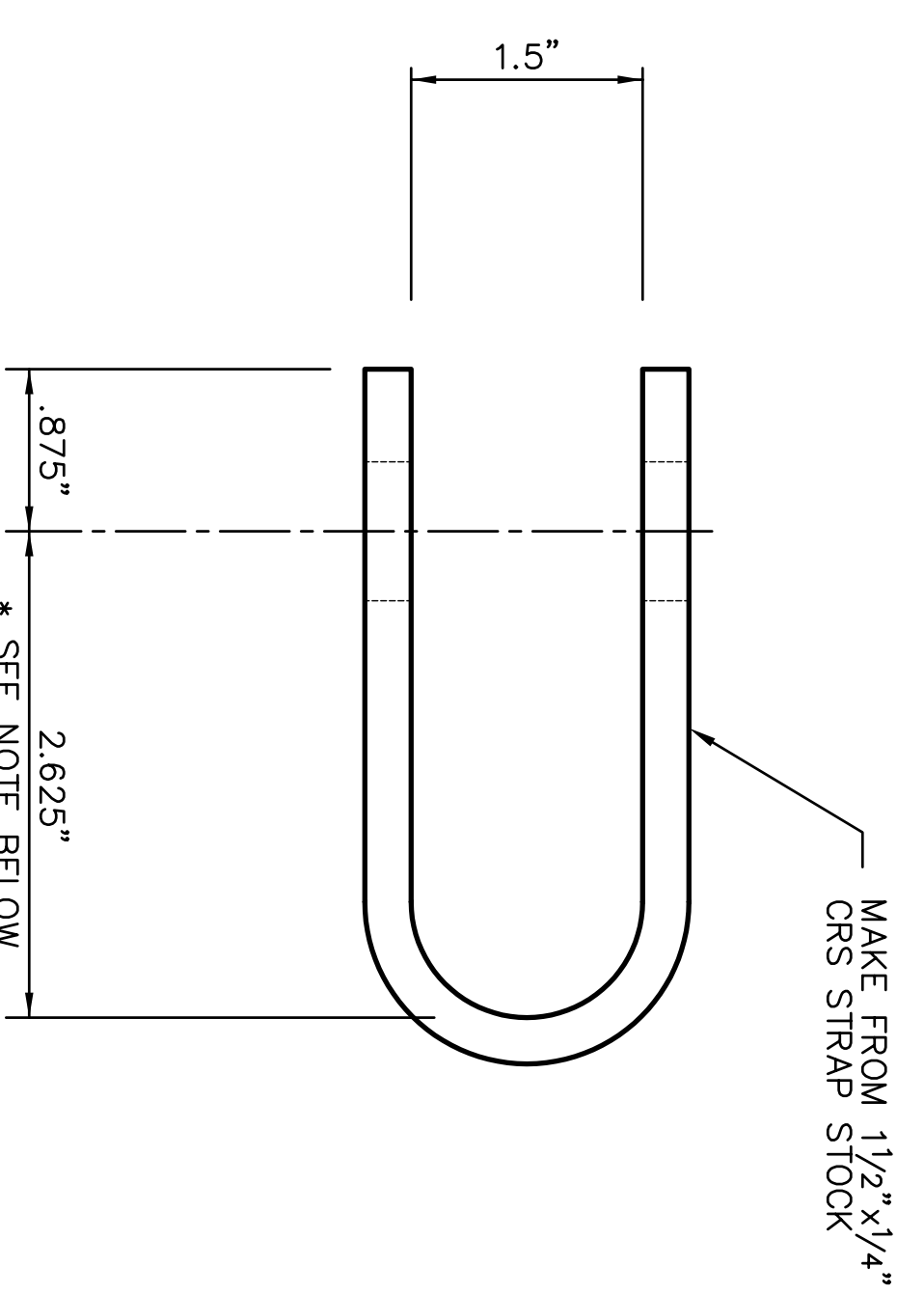
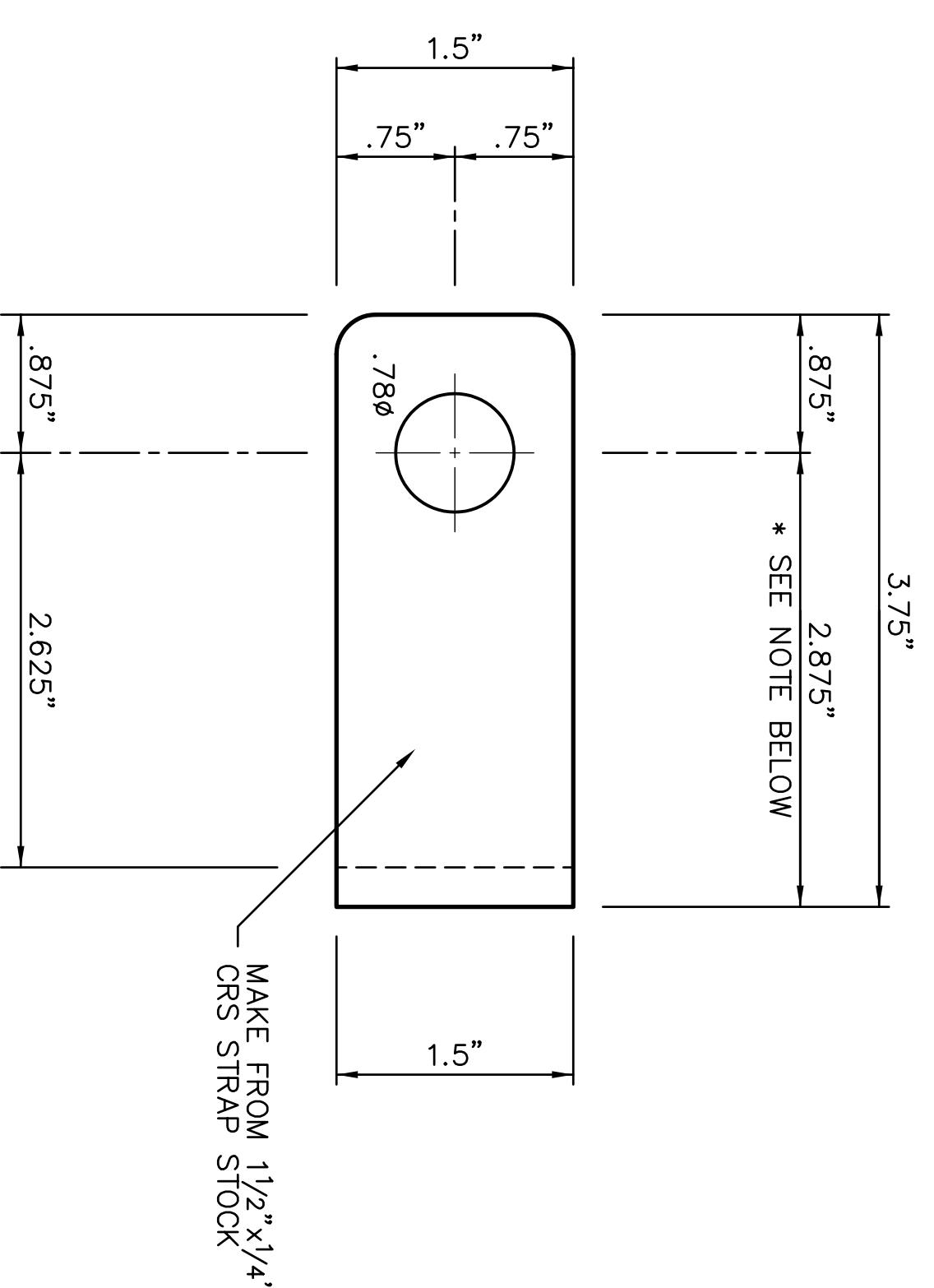
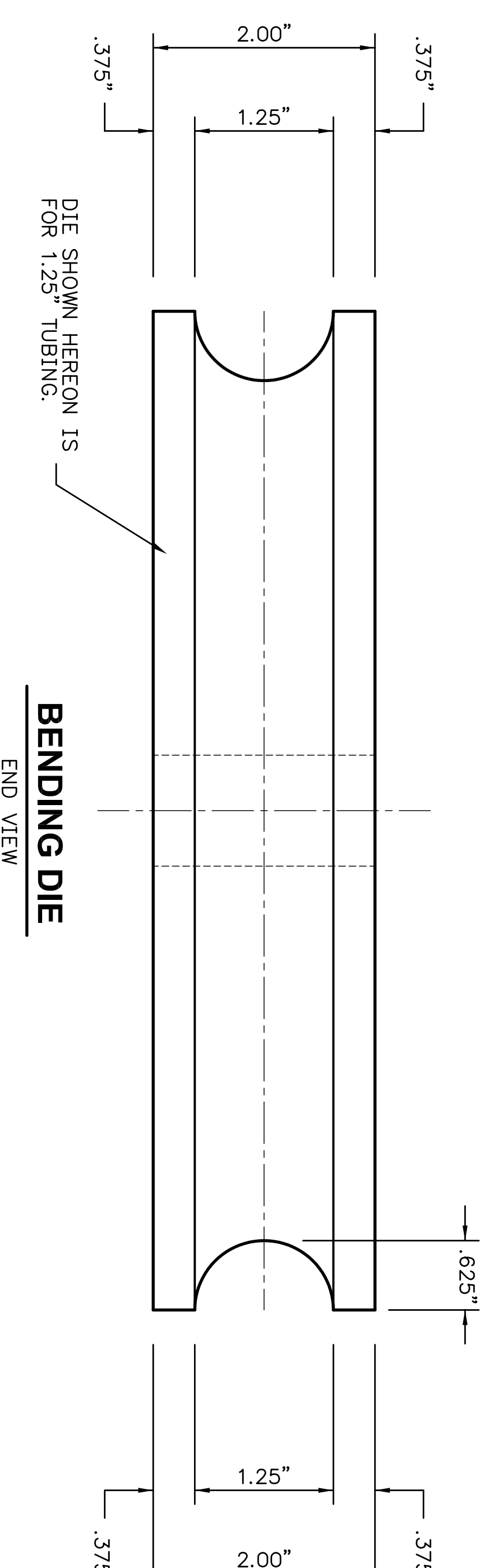

\* DEPENDING UPON THE EXACT GEOMETRY OF YOUR FOLLOW BAR YOU MAY FIND THAT THIS DIMENSION NEEDS TO BE LONGER BY ABOUT 1/16" TO 1/8".

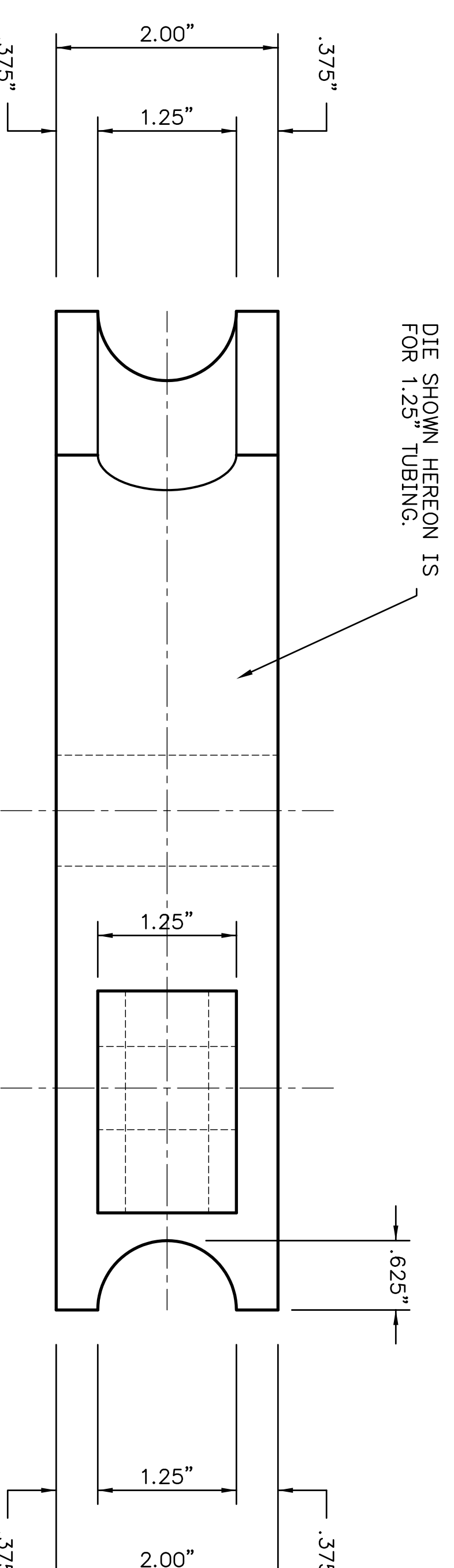
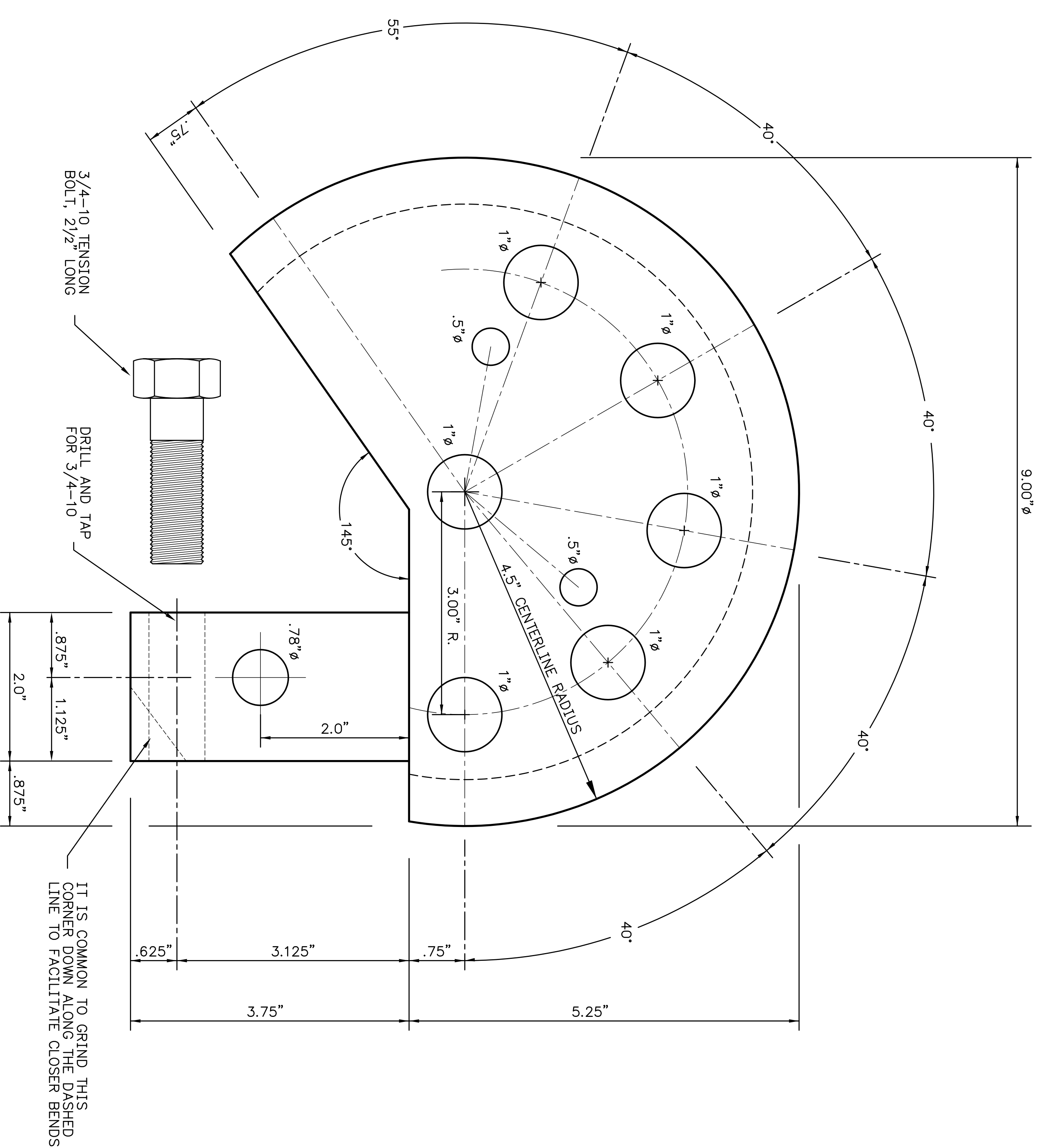

**BENDING DIE**  
 END VIEW

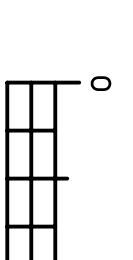

**CHOPPER BUILDERS HANDBOOK**

**BUDGET TUBING BENDER**

Drawn By	QW
Date	7-20-06
Checked By	HC
Date	7-24-06
Scale	1" = 1"
Proj. No.	-
Sheet No.	-

**TYPICAL JD-SQUARED 4.5" CLR. DIE**

**CBTB-5.1**